



The Name You Can Trust ...



CROWN[®] Series Product Catalogue



CONTENTS

Introduction	01
CA SERIES Wiring Accessories	
Flush Switches	02 - 03
Flush Socket Outlet 13 Amp	02 - 03
Flush Socket Outlet 15 Amp	02 - 03
Flush Accessories	04 - 05
Metal-Clad Switches	04 - 05
Metal-Clad Socket Outlet	06 - 07
Flush Socket Outlet Colour 13 Amp	06 - 07
CE SERIES Wiring Accessories	
Flush Switches	08 - 09
Flush Socket Outlet	08 - 09
Flush Accessories	08 - 09
CM SERIES Wiring Accessories	
Flush Switches	10 - 11
Flush Socket Outlet	10 - 11
Flush Double Pole Switches & Intermediate Switches	10 - 11
Flush Accessories	12 - 13
Flush Hotel Accessories	14 - 15
Circuit Breaker	
Miniature Circuit Breaker	16
Residual Current Circuit Breaker	17
Moulded Case Circuit Breaker	17
Isolator	18
Switch Fuse	18
Din-Rail Metal-Clad Electrical Distribution Enclosure	19 - 21
Fan	
Industrial Fan	22 - 25
Ventilating Fan	26 - 27
Domestic Wall Fan & Ceiling Fan	28 - 29
Automatic Hand Dryer	30

The Name You Can Trust ...



Company Profile Of Fortune Electrical Corporation (M) Sdn. Bhd.

Fortune Electrical Corporation (M) Sdn. Bhd. (hereinafter referred to as "Fortune Electrical") is a Malaysian company incorporated in 1994 by Mr. James Foo to manufacture and market a wide range of electrical products to meet the exacting demands of industrial and retail customers.

Fortune Electrical distributes its own *CROWN*® brand of product that it manufactures itself or made through its contract manufacturers under stringent quality control adhering to the highest international standards. *CROWN*® is awarded the 2011 Malaysia Power Brand in electrical products for outstanding achievement of best quality products and services.

Fortune Electrical corporate mission is to serve its customers by striving to achieve and maintain excellence in every facet of its relationships with its customers. It recognizes the importance of smart partnerships and seeks continuous improvement by adding value to every activity with a view to "customer's prosperity". Given this paradigm, Fortune Electrical strives to maintain its relevance in an increasing competitive business environment.

All the employees at Fortune Electrical espouse and embrace the principal of Total Quality Management (Commonly referred to as "TQM") in order to consistently conform to its customers expectation. They are a highly motivated work force, passionate, intense, focussed and undergo continuous training to upgrade skills and knowledge. It is through such acquisitions of skills and knowledge that has and will keep the company at the forefront of development and ever ready to add value and serve its customers effectively and efficiently.

The range of products distributed by Fortune Electrical can be distinctly divided into the following categories : Industrial Products, Commercial Products and Consumer Products.

Fortune Electrical is now poised to enter new markets within the ASEAN countries given the staged implementation of AFTA. As the company expands its activities, further benefits will accrue to its existing loyal customers, in particular in the area of pricing given an economies of large scale production and distributions. To its new customers, its presence will provide an alternative source of quality supply in its value chain.

Fortune Electrical is your trusted partner in the value chain of your business and will strive to maintain its relevancy at all times to maintain mutually beneficial relationships with all its customers. It espoused the belief that it cannot look good until and unless its business partner look good! This pledge is the ultimate customers assurance. "Together We Grow"

INTRODUCTION





CA SERIES WIRING ACCESSORIES

The Name You Can Trust ...

FLUSH SWITCHES



CA 101 FN
10AX 1 Gang 1 Way Flush Switch
CA 102 FN
10AX 1 Gang 2 Way Flush Switch



CA 103 FN
10AX 2 Gang 1 Way Flush Switch
CA 104 FN
10AX 2 Gang 2 Way Flush Switch



CA 105 FN
10AX 3 Gang 1 Way Flush Switch
CA 106 FN
10AX 3 Gang 2 Way Flush Switch



CA 107 FN
10AX 4 Gang 1 Way Flush Switch
CA 108 FN
10AX 4 Gang 2 Way Flush Switch



CA 109 FN
10AX 5 Gang 1 Way Flush Switch
CA 110 FN
10AX 5 Gang 2 Way Flush Switch



CA 242 FN
20 AMP Double Pole Switch
c/w Neon Indicator

FLUSH SOCKET OUTLET 13AMP



CA 130 FN
13 Amp Flush Switched Socket Outlet



CA 132 FN
13 Amp Twin Flush Switched Socket Outlet



CA 131 FN
13 Amp Flush Switched Socket Outlet
c/w Neon Indicator

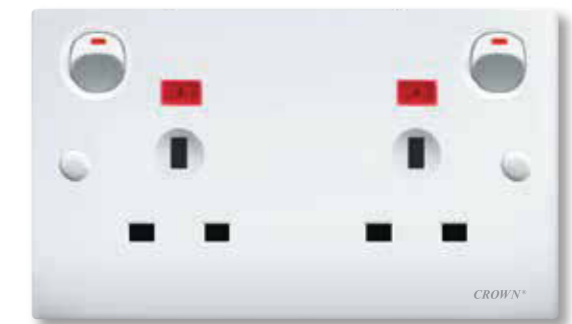

CA 136 FN
13 Amp Twin Flush Switched Socket Outlet
c/w Neon Indicator

FLUSH SOCKET OUTLET 15AMP



CA 126 FN
15 Amp Flush Socket Outlet



CA 137 FN
15 Amp Flush Switched Socket Outlet



CA 142 FN
15 Amp Flush Switched Socket Outlet
c/w Neon Indicator





CA SERIES WIRING ACCESSORIES

The Name You Can Trust ...

FLUSH ACCESSORIES



CA 128 F
1 Gang Bell Press



CA 128 FT
2 Gang Bell Press



CA 139 F
500 Watt Light Dimmer c/w 1 Gang Switch



CA 127 F
1 Gang Single T.V. Socket Outlet



CA 124 F
2 Gang Single T.V. Socket Outlet



CA 3033 F
1 Gang Astro Socket Outlet



CA 135 F
1 Gang Single Telephone Socket Outlet



CA 147 F
2 Gang Single Telephone Socket Outlet



CS 149 F
Computer Socket - CAT 5 Enhance
Socket Outlet



CA 3388 F
Astro & T.V. Socket Outlet



CA 3333 F
On-off Push Button

METAL-CLAD SWITCHES



MC A 01
10AX 1 Gang 1 Way Switch
MC A 02
10AX 1 Gang 2 Way Switch



MC A 03
10AX 2 Gang 1 Way Switch
MC A 04
10AX 2 Gang 2 Way Switch



MC A 05
10AX 3 Gang 1 Way Switch
MC A 06
10AX 3 Gang 2 Way Switch



MC A 07
10AX 4 Gang 1 Way Switch
MC A 08
10AX 4 Gang 2 Way Switch



CA SERIES WIRING ACCESSORIES

The Name You Can Trust ...

METAL-CLAD SOCKET OUTLET



MC 109 SS
13 Amp Switched Socket Outlet



MC 111 TSS
13 Amp Twin Switched Socket Outlet



MC 115 SS
15 Amp Switched Socket Outlet



FLUSH SOCKET OUTLET COLOUR 13AMP



CA 130 FN (BLACK)
13 Amp Flush Switched Socket Outlet



CA 132 FN (BLACK)
13 Amp Twin Flush Switched Socket Outlet

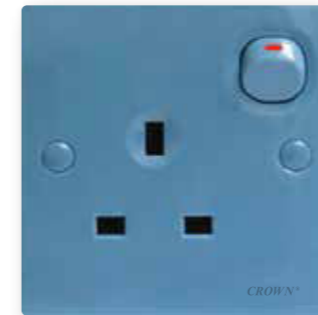

CA 130 FN (BLUE)
13 Amp Flush Switched Socket Outlet

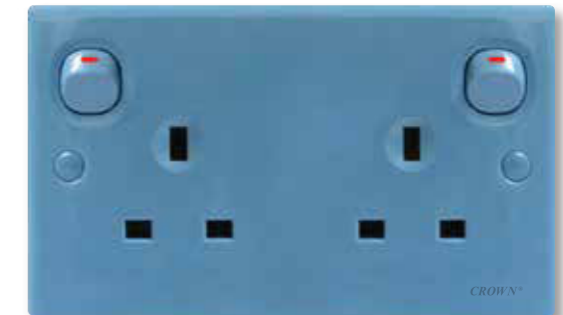

CA 132 FN (BLUE)
13 Amp Twin Flush Switched Socket Outlet



CA 130 FN (RED)
13 Amp Flush Switched Socket Outlet



CA 132 FN (RED)
13 Amp Twin Flush Switched Socket Outlet



CA 130 FN (YELLOW)
13 Amp Flush Switched Socket Outlet

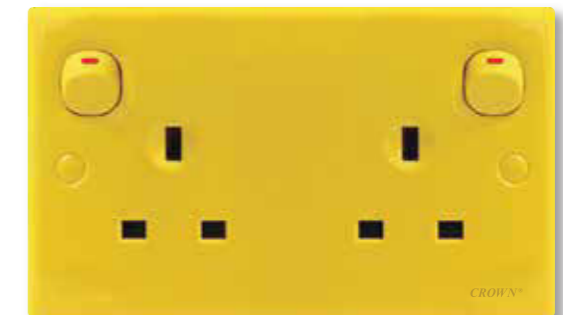

CA 132 FN (YELLOW)
13 Amp Twin Flush Switched Socket Outlet



CE SERIES WIRING ACCESSORIES

The Name You Can Trust ...

FLUSH SWITCHES



CE 8011 B
10AX 1 Gang 1 Way Flush Switch
CE 8012 B
10AX 1 Gang 2 Way Flush Switch

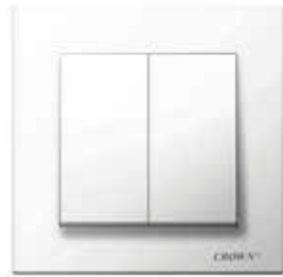

CE 8021 B
10AX 2 Gang 1 Way Flush Switch
CE 8022 B
10AX 2 Gang 2 Way Flush Switch

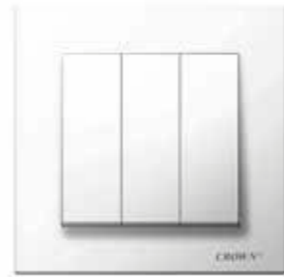

CE 8031 B
10AX 3 Gang 1 Way Flush Switch
CE 8032 B
10AX 3 Gang 2 Way Flush Switch



CE 8041 B
10AX 4 Gang 1 Way Flush Switch
CE 8042 B
10AX 4 Gang 2 Way Flush Switch



CE 820 NB
20 Amp Double Pole
Flush Switch c/w Neon Indicator

FLUSH SOCKET OUTLET



CE 813 SB
13 Amp Flush Switched Socket Outlet



CE 813 TSB
13 Amp 2 Gang Flush Switched Socket Outlet



CE 815 SB
15 Amp Flush Switched Socket Outlet



CE 5901 S
Universal
Switched Socket Outlet



CE 813 SNB
13 Amp
Flush Switched Socket Outlet
c/w Neon Indicator



CE 813 TSNB
2 Gang Flush Switched Socket Outlet
c/w Neon Indicator



CE 815 SNB
15 Amp
Flush Switched Socket Outlet
c/w Neon Indicator

FLUSH ACCESSORIES



CE 3010 B
1 Gang Bell Switch



CE 3020 B
2 Gang Press Switch

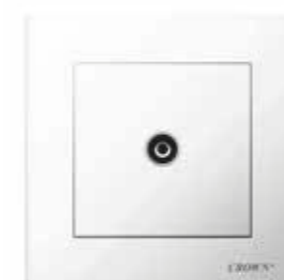

CE 6001 B
1 Gang T.V. Socket Outlet



CE 6005 B
2 Gang T.V. + SAT (Astro)
Socket Outlet



CE 6105 B
1 Gang 8 Wire (RJ45-Cat5e)
Data Outlet - Shuttered



CE 6107 B
2 Gang (RJ11) Telephone +
8 Wire (RJ45-Cat5e) Data Outlet
- Shuttered



CE 2006 B
1 Gang 8 Wire (RJ45-Cat6)
Data Outlet - Shuttered



CE 6101 B
1 Gang 4 Wire (RJ11)
Telephone Socket Outlet
- Shuttered

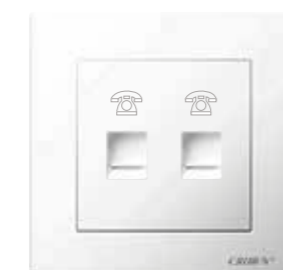

CE 6102 B
2 Gang 4 Wire (RJ11)
Telephone Socket Outlet
- Shuttered



CE 6004 B
1 Gang SAT (Astro)
Socket Outlet



CE 4011 B
500 Watt Light Dimmer



CM SERIES WIRING ACCESSORIES

The Name You Can Trust ...

FLUSH SWITCHES



CM 5011
16AX 1 Gang 1 Way Flush Switch
CM 5012
16AX 1 Gang 2 Way Flush Switch



CM 5021
16AX 2 Gang 1 Way Flush Switch
CM 5022
16AX 2 Gang 2 Way Flush Switch



CM 5031
16AX 3 Gang 1 Way Flush Switch
CM 5032
16AX 3 Gang 2 Way Flush Switch



CM 5041
16AX 4 Gang 1 Way Flush Switch
CM 5042
16AX 4 Gang 2 Way Flush Switch

FLUSH SOCKET OUTLET



CM 613S
13 Amp Flush Switched Socket Outlet



CM 613TS
13 Amp 2 Gang Flush Switched Socket Outlet

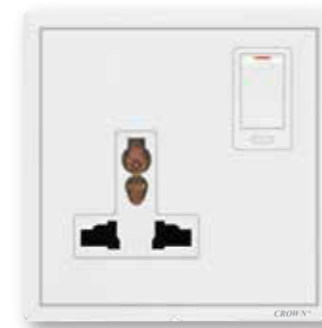

CM 2015
13 Amp Flush Universal Switched Socket Outlet



CM 2016
13 Amp Flush Switched Socket Outlet
c/w USB Outlet



CM 615S
15 Amp Flush Switched Socket Outlet

FLUSH DOUBLE POLE SWITCHES



CM 620N
20 Amp 1 Gang 1 Way Double Pole Flush Switch c/w Neon Indicator
CM 2012
20 Amp 1 Gang 2 Way Double Pole Flush Switch c/w Neon Indicator



CM 2032
32 Amp 1 Gang 1 Way Double Pole Flush Switch
c/w Neon Indicator

INTERMEDIATE SWITCHES



CM 2013
16AX 1 Gang Intermediate Switch



CM SERIES WIRING ACCESSORIES

The Name You Can Trust ...

FLUSH ACCESSORIES



CM 3010
16AX 1 Gang Bell Switch



CM 3020
16AX 1 Gang Press Switch



CM 4011
500W Rotary Light Dimmer



CM 6001
1 Gang T.V. Socket Outlet



CM 6002
2 Gang T.V. Socket Outlet



CM 6003
1 Gang SAT (Astro)
Socket Outlet



CM 6005
2 Gang T.V. + SAT (Astro)
Socket Outlet



CM 6101
1 Gang 4 Wire (RJ11)
Telephone Socket Outlet - Shuttered



CM 6102
2 Gang 4 Wire (RJ11)
Telephone Socket Outlet - Shuttered



CM 6105
1 Gang 8 Wire (RJ45-Cat5e)
Data Outlet - Shuttered



CM 6106
2 Gang 8 Wire (RJ45-Cat5e)
Data Outlet - Shuttered



CM 2006
1 Gang 8 Wire (RJ45-Cat6)
Data Outlet - Shuttered



CM 6107
2 Gang (RJ11)Telephone + 8 Wire (RJ45-Cat5e)
Data Outlet - Shuttered



CM SERIES WIRING ACCESSORIES

The Name You Can Trust ...

FLUSH HOTEL ACCESSORIES



CM 2007
20A Key Card c/w 30 Second Delay Off



CM 7033
20A 3 Gang LED Switch c/w
[Don't Disturb], [Please Wait],
[Clean Up] Indicator



CM 7133
16AX Bell Press c/w
[Don't Disturb], [Clean Up],
[Please Wait] Indicator



CM 7022
20A 2 Gang LED Switch c/w
[Don't Disturb], [Clean Up]
Indicator



CM 7122
16AX Bell Press c/w
[Don't Disturb], [Clean Up]
Indicator



CM 7004D
115V Shaver Outlet

COLOUR SELECTION



PURE WHITE



METALIC SILVER



METALIC GOLD



MATT BLACK

MINIATURE CIRCUIT BREAKER (MCB)

1 POLE MCB

Model Number: FEC 88



Cat. No.	Rated Current	Colour	Rated Voltage	Rated Breaking Capacity	Frequency (Hz)	Characteristic	Degree of Protection
CMC 106 B	6 Amp		240V	6 kA	50Hz	B/C	IP40 (after installation in board)
CMC 110 B	10 Amp						
CMC 116 B	16 Amp						
CMC 120 B	20 Amp						
CMC 132 B	32 Amp						
CMC 140 B	40 Amp						
CMC 150 B	50 Amp						
CMC 163 B	63 Amp						

2 POLES MCB

Model Number: FEC 88



Cat. No.	Rated Current	Colour	Rated Voltage	Rated Breaking Capacity	Frequency (Hz)	Characteristic	Degree of Protection
CMC 206 B	6 Amp		240V	6 kA	50Hz	C	IP40 (after installation in board)
CMC 210 B	10 Amp						
CMC 216 B	16 Amp						
CMC 220 B	20 Amp						
CMC 232 B	32 Amp						
CMC 240 B	40 Amp						
CMC 250 B	50 Amp						
CMC 263 B	63 Amp						

3 POLES MCB

Model Number: FEC 88



Cat. No.	Rated Current	Colour	Rated Voltage	Rated Breaking Capacity	Frequency (Hz)	Characteristic	Degree of Protection
CMC 306 B	6 Amp		415V	6 kA	50Hz	C	IP40 (after installation in board)
CMC 310 B	10 Amp						
CMC 316 B	16 Amp						
CMC 320 B	20 Amp						
CMC 332 B	32 Amp						
CMC 340 B	40 Amp						
CMC 350 B	50 Amp						
CMC 363 B	63 Amp						

RESIDUAL CURRENT CIRCUIT BREAKER (RCCB)



2 POLES RCCB

Model Number: FEC 99

Cat. No.	Rated Current	M.A	Frequency (Hz)	Module	Residual non operation current	Residual conditional short circuit current	Machanical life
C2RC4003D	40 Amp	0.03A or 30mA	50Hz	2 Poles	0.5I _{Δn} ~1Δn	3000A to 6000A	10000
C2RC4010D	40 Amp	0.1A or 100mA					
C2RC6303D	63 Amp	0.03A or 30mA					
C2RC6310D	63 Amp	0.1A or 100mA					



4 POLES RCCB

Model Number: FEC 99

Cat. No.	Rated Current	M.A	Frequency (Hz)	Module	Residual non operation current	Residual conditional short circuit current	Machanical life
C4RC4003D	40 Amp	0.03A or 30mA	50Hz	4 Poles	0.5I _{Δn} ~1Δn	3000A to 6000A	10000
C4RC4010D	40 Amp	0.1A or 100mA					
C4RC6303D	63 Amp	0.03A or 30mA					
C4RC6310D	63 Amp	0.1A or 100mA					
C4RC10010D	100 Amp	0.1A or 100mA					

MOULDED CASE CIRCUIT BREAKER (MCCB)



Cat. No.	Rated Current	Rated Breaking Capacity	Module	Rated Voltage	Frequency (Hz)	Characteristic	Degree of Protection
FEC - 63L	63 Amp	25 kA	3 Poles	690V	50Hz	B/C	IP40 (after installation in board)
FEC - 100L	100 Amp						
FEC - 160L	160 Amp						
FEC - 200L	200 Amp	50 kA					
FEC - 100H	100 Amp						
FEC - 160H	160 Amp						
FEC - 200H	200 Amp						



CIRCUIT BREAKER

The Name You Can Trust ...

ISOLATOR



2 POLES ISOLATOR
Model Number: FEC 77

Cat. No.	Rated Current	Module	Rated Voltage	Design According	Type of Mounting	Degree of Protection
CIS 232	32 Amp	2 Poles	240V	IEC/EN 60947-3	DIN rail EN 50022	IP40 (after installation in board)
CIS 240	40 Amp					
CIS 263	63 Amp					



3 POLES ISOLATOR
Model Number: FEC 77

Cat. No.	Rated Current	Module	Rated Voltage	Design According	Type of Mounting	Degree of Protection
CIS 332	32 Amp	3 Poles	415V	IEC/EN 60947-3	DIN rail EN 50022	IP40 (after installation in board)
CIS 340	40 Amp					
CIS 363	63 Amp					

DIN-RAIL METAL-CLAD ELECTRICAL DISTRIBUTION ENCLOSURE



SWITCH FUSE



C A 2 PNSF
32 Amp 1 Pole + Neutral Switch Fuse
C A 1 PNSF
63 Amp 1 Pole Switch Fuse



C A 61 PNSF
63 Amp 1 Pole + Neutral Switch Fuse



C A 32 PNSF
32 Amp 3 Poles Switch Fuse
C A 62 PNSF
63 Amp 3 Poles Switch Fuse

Design According	IEC/EN 60947-3
Rated Voltage	240/415~
Rated Current	32A, 63A
No. of Pole	1P+N, 3P
Fuse Type	DO2
Utilization Category	AC22B
Rated Breaking Capacity	10kA
Frequency	50Hz
Degree of Protection	IP40 (after installation in board)
Terminal Capacity	1-25mm ² , 1-16mm ² (32A 1P+N)
Electrical & Mechanical Endurance	>2000 operating cycles
Type of Mounting	DIN rail EN 50022

SIZE 'S'

Cat. No.	Descriptions	Packing Quantity	Dimension (mm)		
			W	H	D
CS-10	1 Row 10 Ways	5 Pcs / ctn	300	218	95
CS-14	1 Row 14 Ways		370		
CS-18	1 Row 18 Ways		430		
CS-22	1 Row 22 Ways		490		

Dimension(mm)

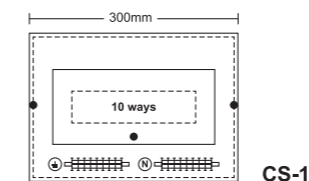

CS-10

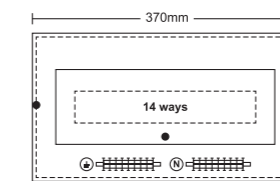

CS-14

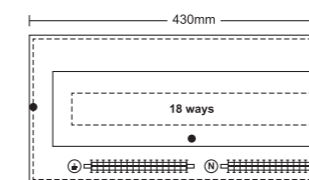
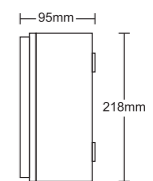

CS-18

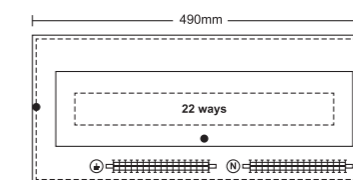

CS-22

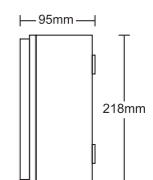



DIN-RAIL METAL-CLAD ELECTRICAL DISTRIBUTION ENCLOSURE

The Name You Can Trust ...

SIZE 'M'

Cat. No.	Descriptions	Packing Quantity	Dimension (mm)		
			W	H	D
CM-2	2 Row 30 Ways	1 Pcs / ctn	400	360	120
CM-2M	2 Row 18 Ways				
CM-3	3 Row 45 Ways				
CM-3M	3 Row 38 Ways				
CM-4	4 Row 60 Ways				
CM-4M	4 Row 53 Ways				
				750	



SIZE 'L'

Cat. No.	Descriptions	Packing Quantity	Dimension (mm)		
			W	H	D
CL-2	2 Row 36 Ways	1 Pcs / ctn	470	360	120
CL-2M	2 Row 24 Ways				
CL-3	3 Row 54 Ways				
CL-3M	3 Row 46 Ways				
CL-4	4 Row 72 Ways				
CL-4M	4 Row 64 Ways				
CL-5	5 Row 90 Ways				
CL-5M	5 Row 82 Ways				
				750	
				890	



Dimension(mm)

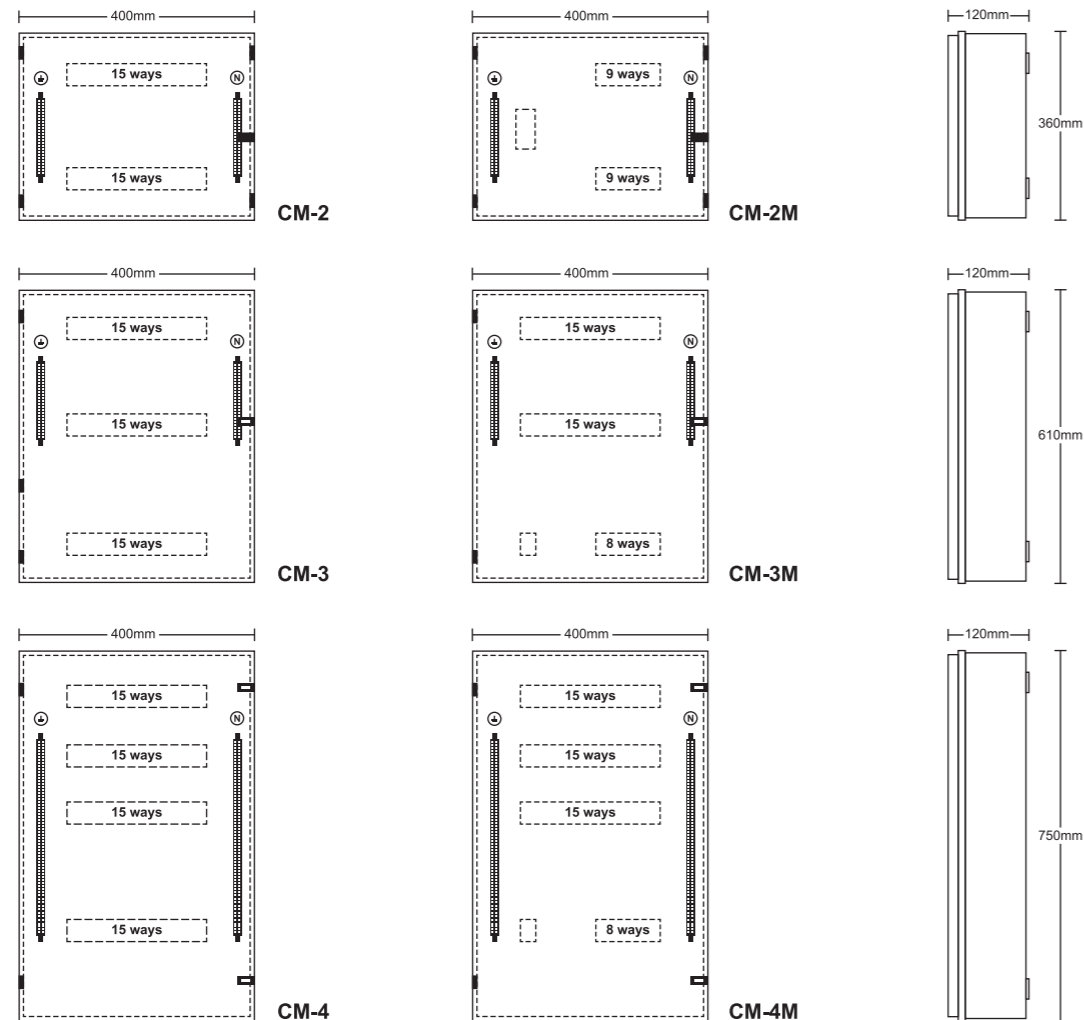

Dimension(mm)

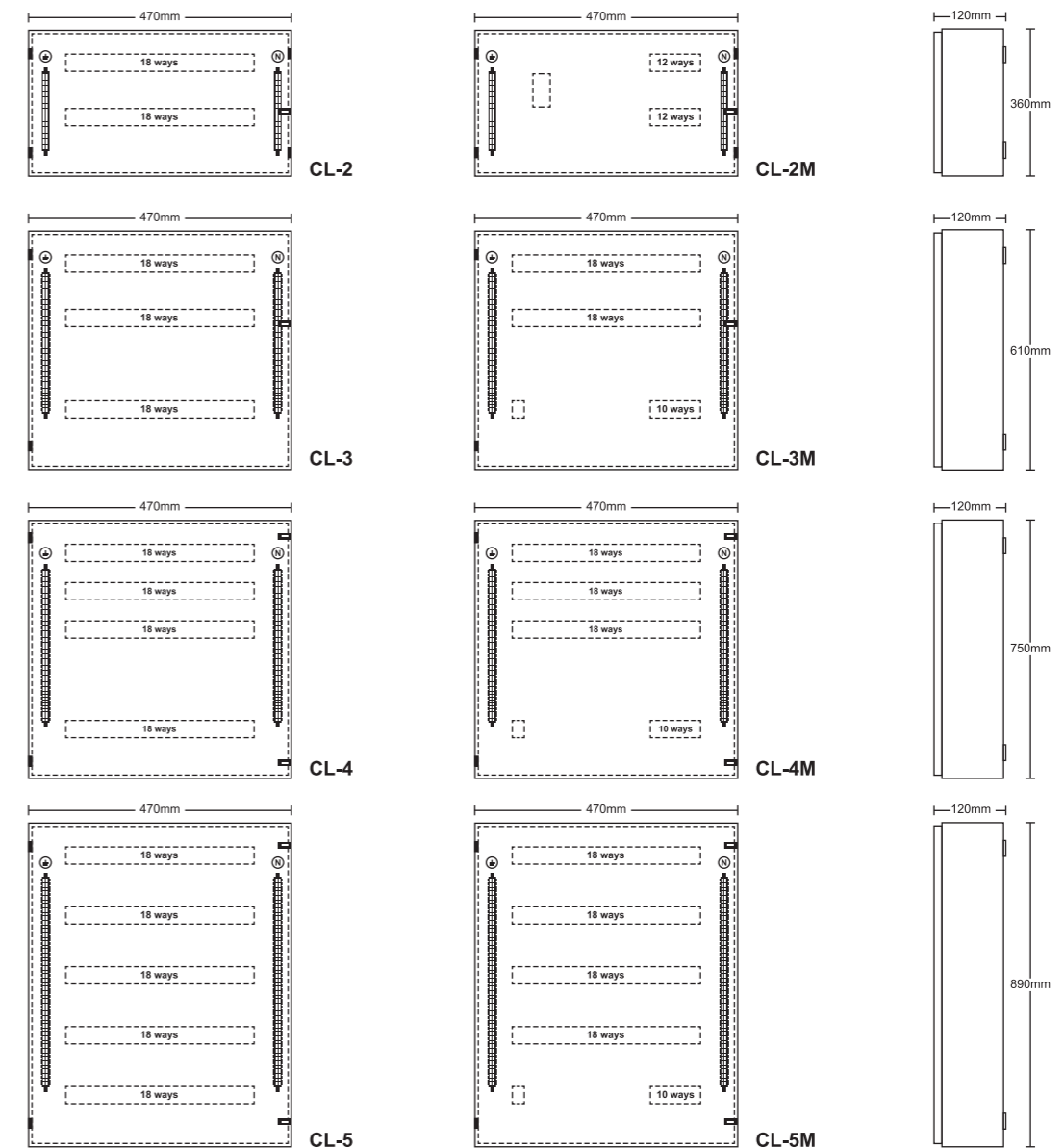



FAN

The Name You Can Trust ...

INDUSTRIAL WALL FAN



TECHNICAL DATA

Cat. No.	Size	Phase	Voltage (V)	Power (W)	RPM	CFM
FW-65	26"	Single	240	150	1350	7142

INDUSTRIAL WALL FAN (BRONZE)



TECHNICAL DATA

Cat. No.	Size	Phase	Voltage (V)	Power (W)	RPM	CFM
FW-45	18"	Single	240	80	1350	2500

INDUSTRIAL STAND FAN



TECHNICAL DATA

Cat. No.	Size	Phase	Voltage (V)	Power (W)	RPM	CFM
FS-65	26"	Single	240	150	1350	7142

INDUSTRIAL STAND FAN (BRONZE)



TECHNICAL DATA

Cat. No.	Size	Phase	Voltage (V)	Power (W)	RPM	CFM
FS-45	18"	Single	240	80	1350	2500



FAN

The Name You Can Trust ...

INDUSTRIAL WALL FAN (GREY COLOUR)

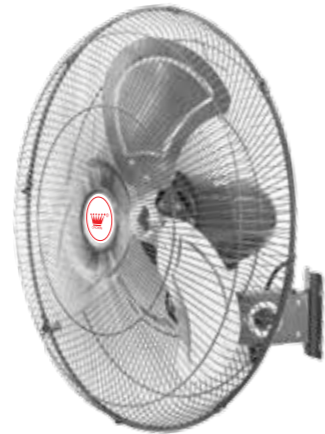

TECHNICAL DATA

Cat. No.	Size	Phase	Voltage (V)	Power (W)	RPM	CFM
FW-45C	18"	Single	240	90	1380	2700
FW-50C	20"	Single	240	110	1380	2850

INDUSTRIAL STAND FAN (GREY COLOUR)



TECHNICAL DATA

Cat. No.	Size	Phase	Voltage (V)	Power (W)	RPM	CFM
FS-45C	18"	Single	240	90	1380	2700
FS-50C	20"	Single	240	110	1380	2850

INDUSTRIAL EXHAUST FAN (HEAVY DUTY)

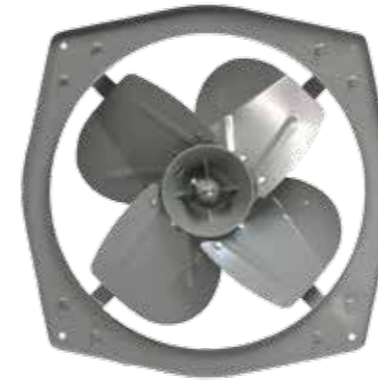

TECHNICAL DATA

Cat. No.	Size	Voltage (V)	Frequency (Hz)	Power (W)	RPM	CFM	Installation Size (mm)					
							A	B	C	D	E	F
FP-30	12"	240	50	100	1440	1300	390	315	325	300	237	9
FP-40	16"	240	50	170	1440	2300	483	387	419	370	265	11
FP-45	18"	240	50	225	1400	3300	560	435	450	430	290	11
FP-50	20"	240	50	230	1380	3150	600	465	500	475	320	11
FP-60	24"	240	50	320	900	7500	698	590	617	595	350	12

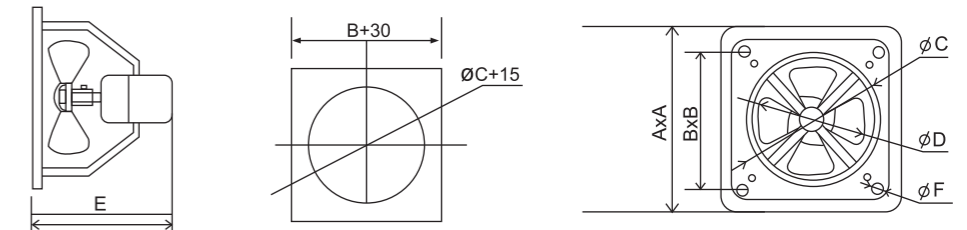

INDUSTRIAL FLOOR FAN



TECHNICAL DATA

Cat. No.	Size	Voltage (V)	Power (W)	RPM	CFM
FE40	16"	240	80	1350	2500
FE45	18"	240	120	1350	2800



TECHNICAL DATA

Cat. No.	Size	Voltage (V)	Power (W)	RPM	CFM
FE-40-2	16"	240	70	1350	2800
FE-45-2	18"	240	100	1350	3300



WALL MOUNTED VENTILATING FAN

TECHNICAL DATA



Cat. No.	Size	Rated Volt ACV/Hz	Power Watt	RPM	Air Delivery m ³ /min	Noise dB[A]	Pack Qty.
VF-20 CW	8"	240/50	28	1250	8.1	45	6
VF-25 CW	10"	240/50	36	1150	12	51	6
VF-30 CW	12"	240/50	48	1050	18	55	4

INSTALLATION SIZE

Cat. No.	Size	A	B	C	D	E	Function Area m ³
VF-20 CW	8"	200	292	242	76	43	20~28
VF-25 CW	10"	250	333	290	80	43	20~28
VF-30 CW	12"	300	393	344	80	43	38~45

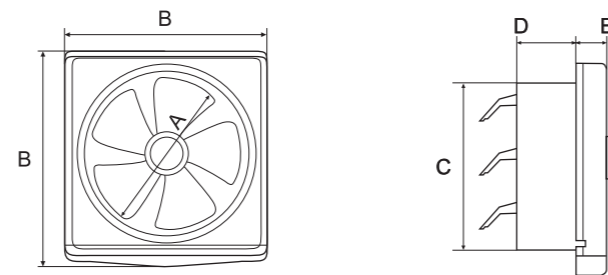

CEILING MOUNTED VENTILATING FAN

TECHNICAL DATA



Cat. No.	Size	Rated Volt ACV/Hz	Power Watt	RPM	Air Delivery m ³ /min	Noise dB[A]	Pack Qty.
APT 20-A1C	8"	240/50	28	1300	7.0	41	4
APT 25-A1C	10"	240/50	36	1150	16.4	45	4

INSTALLATION SIZE

Cat. No.	Size	A	B	C	D	E	F	G	H	Function Area m ³
APT 20-A1C	8"	254	220	302	275	105	13	8	5	8 - 12
APT 25-A1C	10"	310	272	356	330	105	13	8	5	3 - 15

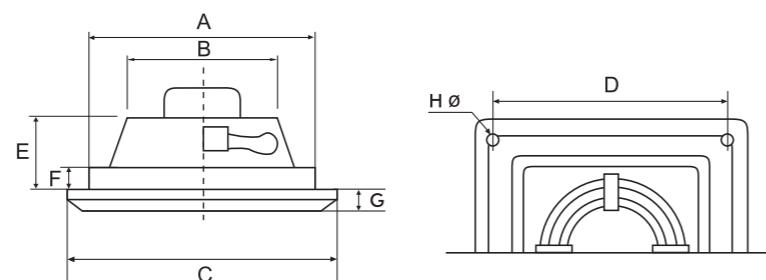

GLASS MOUNTED VENTILATING FAN

TECHNICAL DATA



Cat. No.	Size	Rated Volt ACV/Hz	Power Watt	RPM	Air Delivery m ³ /min	Noise dB[A]	Pack Qty.
APC15-AK	6"	240/50	8	1900	210	35	6
APC20-AK	8"	240/50	16	1800	260	32	6

Cat. No.	Size	A	B	C	D	E	F	G	Function Area m ³
APC15-AK	6"	150	206	38	47	87	145	177	4 - 6
APC20-AK	8"	200	272	49	51	100	180	230	7 - 12

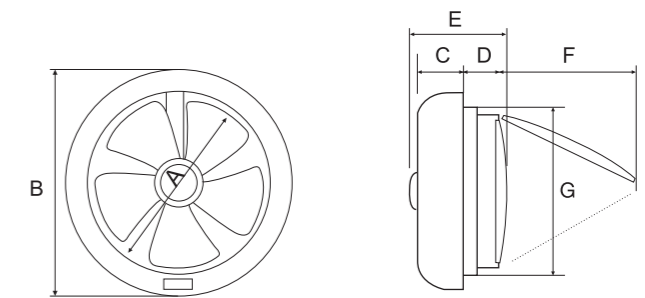

CEILING MOUNTED TUBULAR VENTILATING FAN

TECHNICAL DATA

Cat. No.	Size	Rated Volt ACV/Hz	Power Watt	RPM	Air Delivery m ³ /min	Noise dB[A]	Pack Qty.
APB 15	8"	240/50	24	1250	480	38	4
APB 20	10"	240/50	30	1250	600	40	4
APB 25	12"	240/50	36	1250	720	42	4

INSTALLATION SIZE

Cat. No.	Size	A	B	C	D	E	Function Area m ³
APB 15	8"	205	216	246	50	98	7-15
APB 20	10"	290	300	320	55	98	15-20
APB 25	12"	310	320	340	60	98	20-25

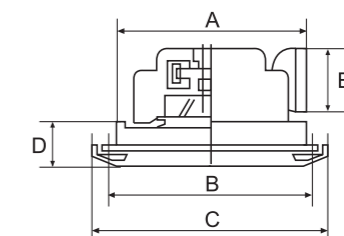



FAN

The Name You Can Trust ...

16" WALL FAN



TECHNICAL DATA

Cat. No.	Size	Phase	Voltage (V)	Power (W)	RPM	CFM
CWF-16S	16"	Single	240	60	1250	1545

16" ORBIT FAN



TECHNICAL DATA

Cat. No.	Size	Phase	Voltage (V)	Power (W)	RPM	CFM
FC-40	16"	Single	240	50	1380	2200

60" CEILING FAN



CF 360



CF 360 B



TECHNICAL DATA

Cat. No	CF 360 / CF 360 B
Colour	White / Brown
Rated Volt ACV/Hz	240/50
Power Watt	85
Air Delivery m ³ / min	204
Noise dB[A]	62
Pack Qty.	2 Sets
Diameter	150cm (60")
Highest Speed RPM	292.18
Lowest Speed RPM	156.67
Installation Class	Class E



AUTOMATIC HAND DRYER

NOTE

The Name You Can Trust ...



TECHNICAL PARAMETERS

Cat. No.	CHD 806
Frequency: 50Hz	Voltage: 240V
Time Delay: 5 Sec	Induction Distance: 5mm ~ 20mm
Power: 1800W	Net Weight: 2.3kg
Current: 8.2A	Volume: 250mm x 238mm x 230mm
Electrical Shockproof Protection: Type I	Splash Proof: IP25

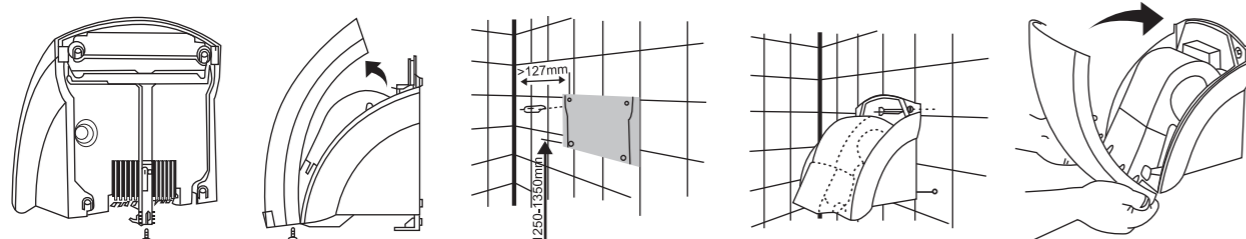





FORTUNE ELECTRICAL CORPORATION (M) SDN. BHD. (283557-V)

No. 7, Jalan Mega 3B, Taman Industri Mega, Bandar Teknologi Kajang, 43500, Semenyih, Selangor Darul Ehsan, Malaysia.

 +603-8723 7573 (Hunting Line)  +603-8723 7593  fortunee@live.com.my  www.fortune-electrical.com.my